

How to setup my TP-Link correctly?

Supportsquare also provides hardware (travel cases with VR-devices) with mifi-routers (tp-link). These can be used as a back up plan when internet connection is not a certainty. To install them correctly, follow these steps.

- To install the TP-link, you need to provide your own SIM/internet card.
- Connect your PC to the hotspot.
- Go to: <http://tplinkmifi.net/>.

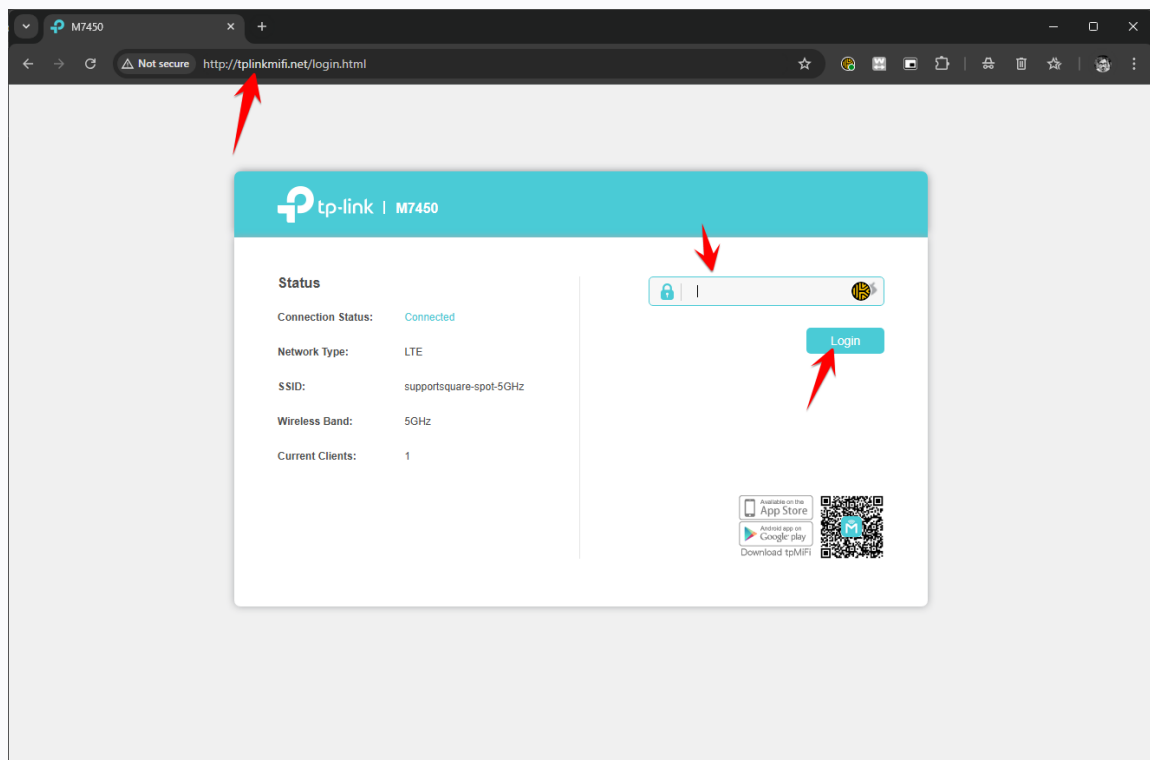

- Login with your admin password.