

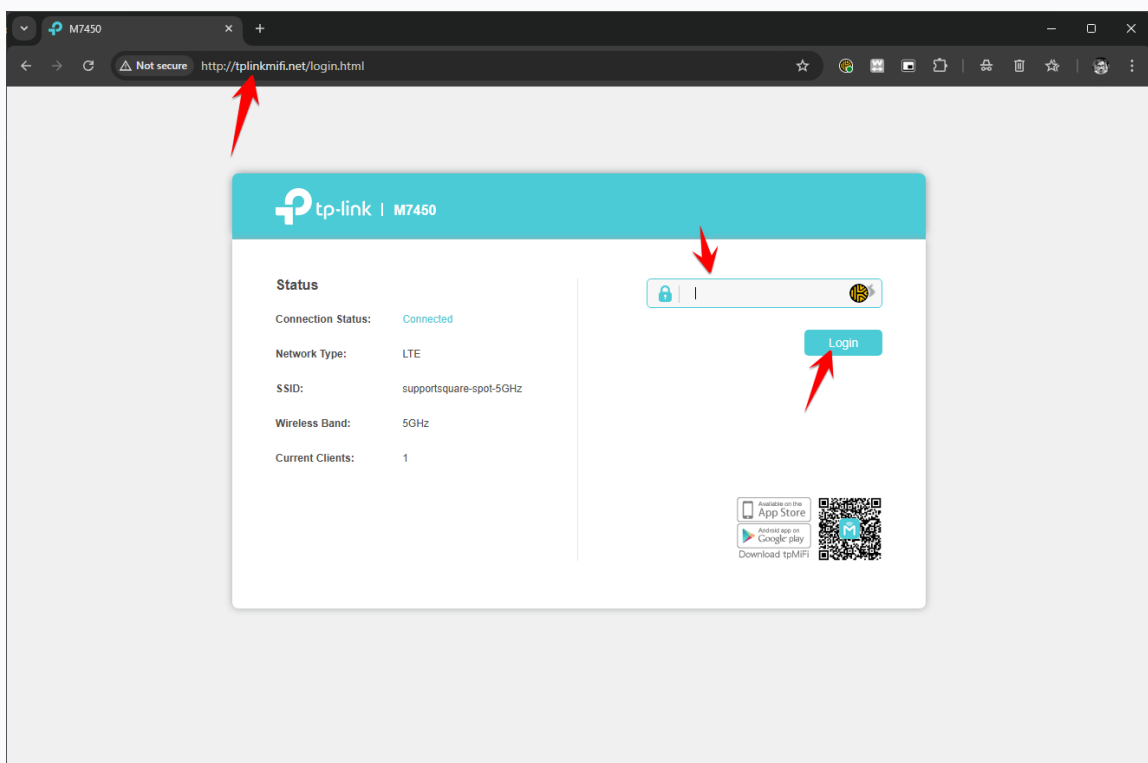

# How to setup my TP-Link correctly?

Supportsquare also provides hardware (travel cases with VR-devices) with mifi-routers (tp-link). These can be used as a back up plan when internet connection is not a certainty. To install them correctly, follow these steps.

- Zorg voor een sim/internet kaart die je in de tp-link kan steken.
- Verbind je PC met de hotspot.
- Go to: <http://tplinkmifi.net/>.



- Login with your admin password.